HP 7475A Color Desktop Plotter



Technical Data

Features

- Two small-format media sizes
- Full range of pen/media combinations
- High-quality output
- Strong software support
- Hardware compatibility
- Built-in intelligence

The HP 7475A color desktop plotter produces high-quality A4/A- and A3/B-size color graphics for business and PC CAD applications. The HP 7475A is ideal for professionals who need the larger drawings for PERT charts, flow charts, project schedules, and design applications. It also produces professional-quality color overheads for presentations and colorful summary charts for handouts and reports.

Full Range of Pen/Media Combinations

HP 7475A users can select from paper (regular and glossy), overhead transparency film, and durable double-matte polyester film. Fiber-tip pens for paper and transparencies come in 10 bright colors and two tip widths. Refillable liquid-ink pens are available for final-quality drawings on polyester film.

High-quality Output

The HP 7475A color desktop plotter combines high resolution and excellent repeatability to ensure professional-quality output. It has an addressable resolution of 0.025 mm (0.001 in.), so it can plot up to 1000 points in a one-inch line.

The *one* plotter for both CAD and color business graphics

When commanded to return to the same point with no pen change, it does so within 0.1 mm (0.004 in.). This precision means your drawings have straight lines, crisp characters, circles that close, and corners that meet.

Strong Software Support

One of the most widely-supported plotters in the world, the HP 7475A works with major software packages from the entire spectrum of graphics applications—integrated software, business graphics/presentations, computer-aided-design/drafting, scientific and statistical analysis, project scheduling, and more.

Hardware Compatibility

A choice of two interfaces makes it easy to add an HP 7475A to almost any system—personal computers, mainframes, even smart instruments. The HP 7475A comes with RS-232-C/CCITT V.24 and HP-IB (IEEE 488-1978) interface options. And with an additional eavesdrop cable, the RS-232-C plotter can be connected in series between a computer and a terminal.

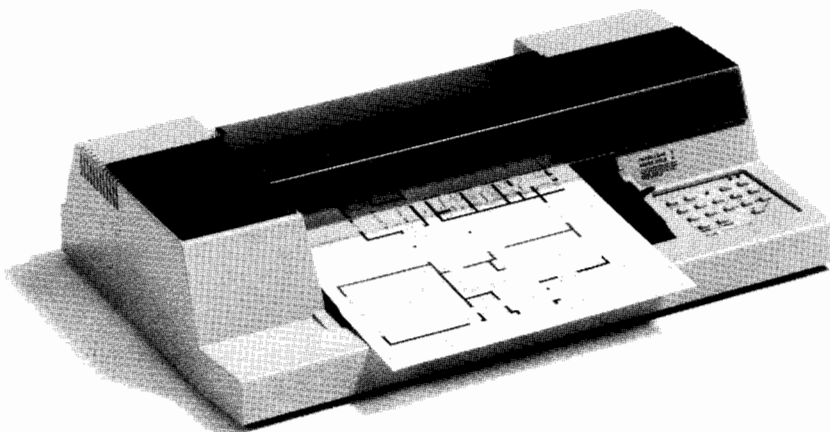

Built-in Intelligence

The HP 7475A's control-panel keys can alter the size of the drawing area when switching media sizes or rotate the plot 90 degrees. Control-panel keys can also be used in conjunction with a digitizing sight.

Programmers will appreciate the intelligence features which eliminate the need for software-generated characters and functions. Hewlett-Packard Graphics Language (HP-GL) instructions (more than 50) govern such tasks as labeling, pen movement, and drawing arcs and circles.

Technical Information

Media Sizes

210 × 297 mm (ISO A4)

8½ × 11 in. (ANSI A)

297 × 420 mm (ISO A3)

11 × 17 in. (ANSI B)

Pens

Number: 6 in carousel

Type: Fiber-tip (paper and transparency), refillable short-body liquid-ink

Media

Paper (regular and glossy), transparency film, double-matte polyester film

Character Sets

French/German, HP 9825, Scandinavian, Spanish/Latin American, Roman Extensions, and these ISO registered sets: ANSI ASCII (006), French (025), German (021), International Reference Version (002), Italian (015), JIS ASCII (014), Katakana (013), Norwegian I (060), Norwegian II (016), Portuguese (016), Spanish (017), Swedish (010), Swedish for Names (011), United Kingdom (004)

Resolution

Addressable: 0.025 mm (0.001 in.)

Mechanical: 0.025 mm (0.001 in.)

Repeatability

With a given pen: 0.1 mm (0.004 in.)

Pen to pen: 0.2 mm (0.008 in.)

Pen Velocity

Pen down, maximum: 38.1 cm/s (15.0 in./s)

Pen up: 50.8 cm/s (20.0 in./s)

Programmable: approximately 0.4 to 38.1 cm/s (0.2 to 15.0 in./s) in increments of 0.4 cm/s

Acceleration

Approximately 2 g

Maximum Plotting Area

Pen axis: 258.0 mm (10.2 in.) for A/B; 275.0 mm (10.8 in.) for A4/A3

Paper axis: 198.0 mm (7.80 in.) for A; 192.0 mm (7.56 in.) for A4; 414.0 mm (16.3 in.) for B; 402.0 mm (15.8 in.) for A3

Buffer Size

1024 bytes

Environmental Ranges

Temperature

Operating: 0 to 55 degrees C (32 to 131 degrees F)

Storage: -40 to 75 degrees C (-40 to 167 degrees F)

Humidity

Operating: 5 to 95% (at 40 degrees C)

Power Requirements

Source: 100, 120, 220, 240 V, -10%, +5%

Frequency: 48-66 Hz

Consumption: 35 W maximum

Physical Specifications

Height: 127.0 mm (5.0 in.)

Width: 568.0 mm (22.4 in.)

Depth: 367.0 mm (14.5 in.)

Net weight: 7.0 kg (16.0 lb)

Shipping weight: approx. 11.0 kg (25.0 lb)

Product Certifications

FCC certified to conform to limits set for radio frequency when used with a Class B computing device; meets or exceeds IEC-380, IEC-435, IEC-478, and CSA C22.2 No. 154.

Interface and Cable Requirements

System	Cable
HP Vectra PC with HP 24540A/B serial/parallel interface card or HP 24541A/B dual serial interface card using 9-pin connector	HP 24542G
HP Vectra PC with HP 24541A/B dual serial interface card using 25-pin connector	HP 17255M
HP Touchscreen PC using serial interface	HP 17255M
HP Touchscreen PC using HP-IB interface	HP 10833A (1.0 m) HP 10833B (2.0 m) HP 10833C (3.0 m) HP 10833D (0.5 m)
HP 3000 or DEC VAX in eavesdrop configuration	HP 17455A
IBM PS/2, PC, PC-XT, and compatibles	HP 17255D
IBM AT and compatibles	HP 24542G
Apple Macintosh 128K and 512K	HP 92219M
Apple Macintosh SE, Macintosh Plus, and Macintosh II	HP 17302A
Apple IIe	HP 17355M

Ordering Information

Standard Unit

7475A

Color desktop plotter

Option numbers:

001 RS-232-C/CCITT V.24 interface

002 HP-IB (IEEE 488-1978) interface

Note: Interface cables must be ordered separately

Accessories Included

Operation and Interconnection Manual (language appropriate to plotter destination)

Reference Card

Power cord (appropriate to plotter destination)

Plotter paper

50 sheets, A4/A size (paper sizes determined by plotter destination)

Transparency film sampler, A4/A size (film sizes determined by plotter destination)

Six-pen carousel for fiber-tip pens

Assorted fiber-tip paper and transparency pens

HP Plotter Supplies Catalog

Accessories Available

07475-90000	Hardware Support Manual
07475-90001	Interfacing/Programming Manual
5061-5080	Additional fiber-tip pen carousel
07475-60030	Liquid-ink drafting pen carousel

For a complete list of available supplies, check the current version of the HP Plotter Supplies Catalog or the Hewlett-Packard PC Peripherals Price Guide.

United States:

Hewlett-Packard Company
4 Choke Cherry Road
Rockville, MD 20850
301 670 4300

Hewlett-Packard Company
5201 Tollview Drive
Rolling Meadows, IL 60008
312 255 9800

Hewlett-Packard Company
5161 Lankershim Blvd.
No. Hollywood, CA 91601
818 505 5600

Hewlett Packard Company
2015 South Park Place
Atlanta, GA 30339
404 955 1500

Canada:

Hewlett-Packard Ltd.
6877 Goreway Drive
Mississauga, Ontario L4V1M8
416 678 9430

Australia/New Zealand:

Hewlett-Packard Australia Ltd.
31-41 Joseph Street
Blackburn, Victoria 3130
Melbourne, Australia
03 895 2895

Europe/Africa/Middle East:

Hewlett-Packard S.A.
Central Mailing Department
P.O. Box 529
1180 AM Amstelveen
The Netherlands
31 20/547 9999

Far East:

Hewlett-Packard Asia Ltd.
22/F Bond Centre
West Tower
89 Queensway
Central, Hong Kong
5 848 7777

Japan:

Yokogawa Hewlett-Packard Ltd.
29-21, Takaido-Higashi 3-chome
Suginami-ku, Tokyo 168
03 331 6111

Latin America:

Latin American Region Headquarters
Monte Pelvoux Nbr. 111
Lomas de Chapultepec
11000 Mexico D.F., Mexico
905 596 79 33

**Technical information in this document
is subject to change without notice.**

**Copyright © 1989
Hewlett-Packard Company**

**Printed in USA 2/89
5954-7091**